



General characteristics

- Terminal Output
- Accuracy : Class 0.5 to 5

Input / Output Specifications

Rated primary rating	30A to 1600A
Rated secondary output	5A

Technical Specifications

Rated burden	1.5VA to 10VA
Class of accuracy	0.5 to 5
Thermal Nominal Continuous	120% of In
Rated Current (I _{cth})	
Thermal short circuit current (I _{th})	I _{th} =60 X In for 1 sec
Instrument security factor	FS<5
Max operating voltage (U _m)	720V maximum
Isolation test voltage	3kV AC 1 min
Nominal rated frequency	AC 50Hz
Frequency	50/60Hz

Standard

Applicable standard	IEC 61869-2
---------------------	-------------

Dimensions (All are in mm)

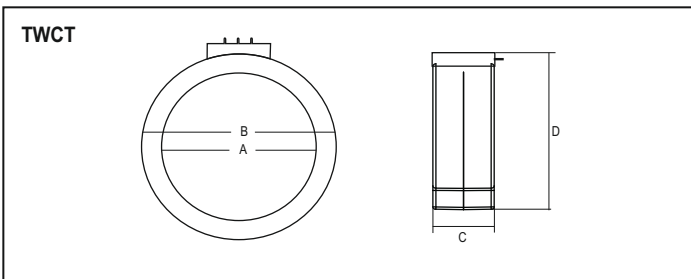

PRODUCT	A	B	C	D
TWCT-T-D35	35	70	45	80
TWCT-T-D55 150/5 A	55	90	35	100
TWCT-T-D55	55	90	25	100
TWCT-T-D65	65	95	30	105
TWCT-T-D110	110	35	35	145
TWCT-T-D120	120	155	25	165

Ordering Information

PRODUCT CODE	WIRE APERTURE In mm	CURRENT RATIO	BURDEN IN VA	ACCURACY CLASS
TWCT-T-D35-30/5A-VA1.5-CL5	DIA 35	30/5	1.5	5
TWCT-T-D35-50/5A-VA5-CL5	DIA 35	50/5	5	5
TWCT-T-D35-75/5A-VA5-CL5	DIA 35	75/5	5	5
TWCT-T-D35-100/5A-VA5-CL1	DIA 35	100/5	5	1
TWCT-T-D35-150/5A-VA5-CL1	DIA 35	150/5	5	1
TWCT-T-D55-150/5A-VA5-CL1	DIA 55	150/5	5	1
TWCT-T-D55-200/5A-VA5-CL1	DIA 55	200/5	5	1
TWCT-T-D55-250/5A-VA5-CL1	DIA 55	250/5	5	1
TWCT-T-D55-300/5A-VA5-CL1	DIA 55	300/5	5	1
TWCT-T-D55-400/5A-VA5-CL1	DIA 55	400/5	5	1
TWCT-T-D65-500/5A-VA5-CL1	DIA 65	500/5	5	1
TWCT-T-D65-600/5A-VA5-CL1	DIA 65	600/5	5	1
TWCT-T-D110-800/5A-VA10-CL0.5	DIA 110	800/5	10	0.5
TWCT-T-D110-1000/5A-VA10-CL0.5	DIA 110	1000/5	10	0.5
TWCT-T-D120-1000/5A-VA10-CL0.5	DIA 120	1000/5	10	0.5
TWCT-T-D120-1200/5A-VA10-CL0.5	DIA 120	1200/5	10	0.5
TWCT-T-D120-1600/5A-VA10-CL0.5	DIA 120	1600/5	10	0.5